

■ The Landmark Bangkok Floor Map

<3rd Floor>

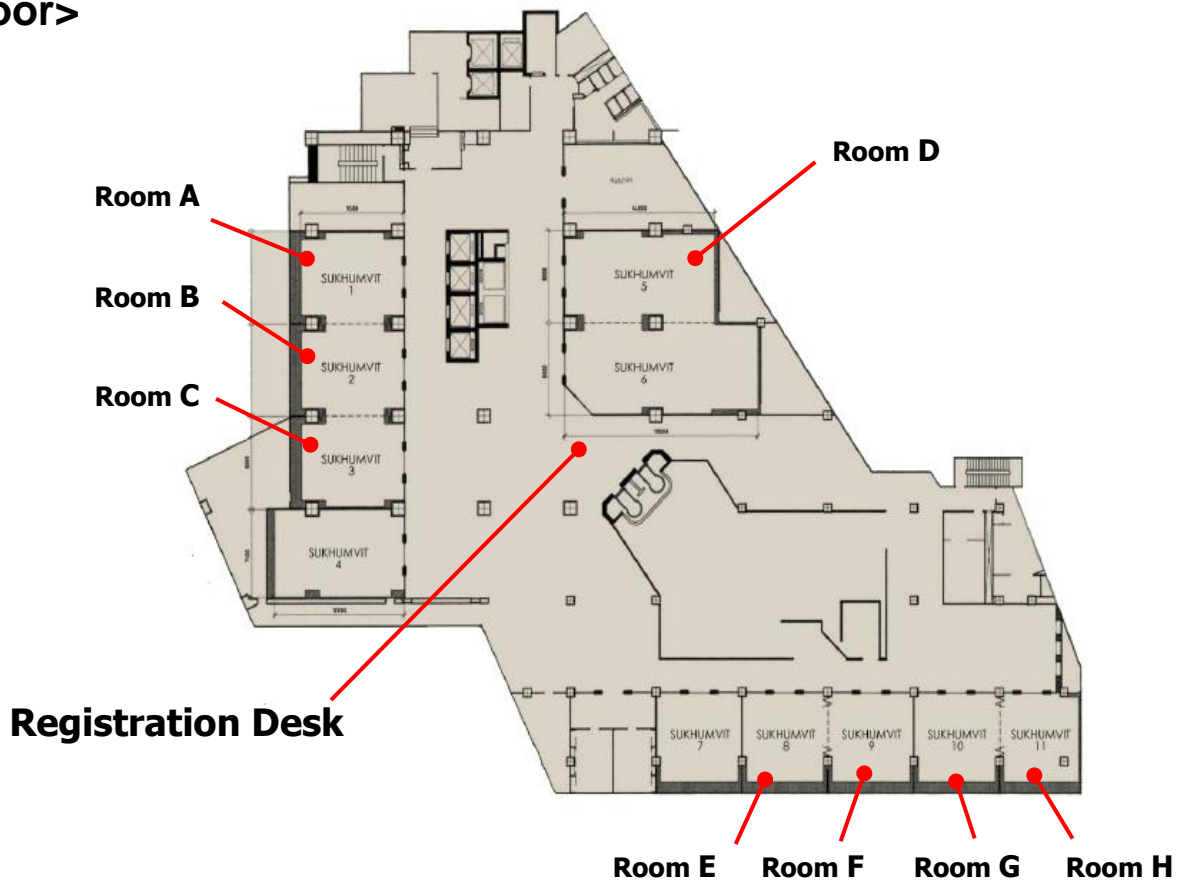

<7th Floor>

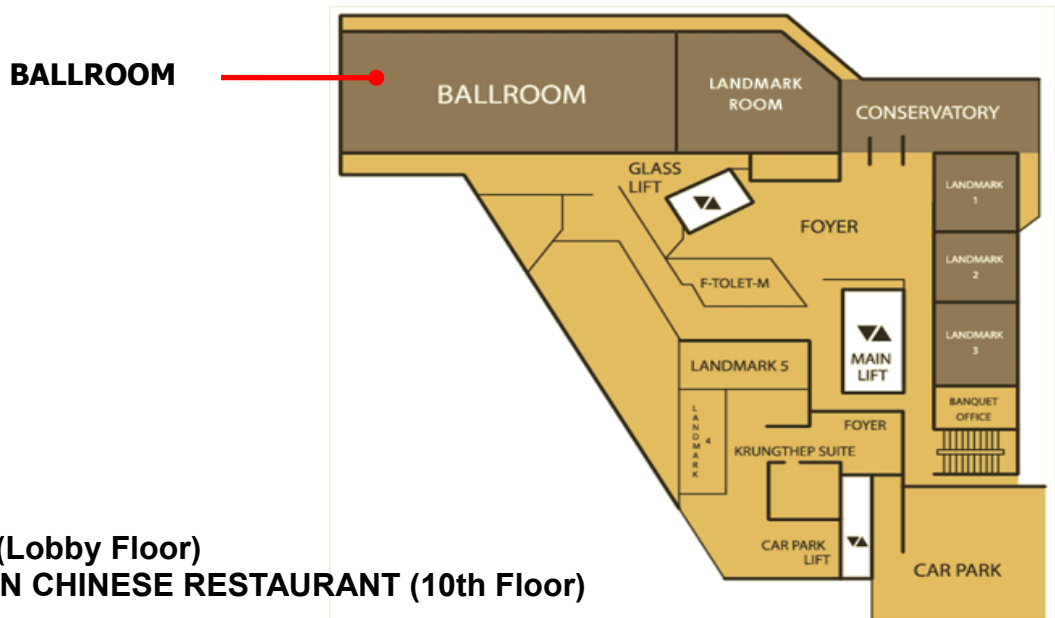

■ Lunch

- >> Atrium (Lobby Floor)
- >> SUI SIAN CHINESE RESTAURANT (10th Floor)

■ Welcome Reception (Nov. 27th)

- >> at SUNDECK of The Landmark Bangkok (11th Floor)

■ ProMAC Gala Dinner (Nov. 30th)

- >> at ANANTARA RIVERSIDE (by Chartered Bus, Dep. Time 16:00)